

INSTALLING A GARBAGE DISPOSAL?

This is a standard basket strainer drain assembly. It is designed for attaching your sink to your standard plumbing drain. It cannot be used with a garbage disposal. If you are installing a garbage disposal, you have to use the "FLANGE" that comes with the disposal.

RUVATI®

INSTALLATION GUIDE

BASKET STRAINER

RVA1022

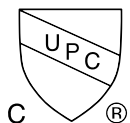

cUPC certified by IAPMO
to meet US and Canada
plumbing standards.



SCAN TO REGISTER
YOUR WARRANTY

or visit
ruvati.com/register

RUVATI®

Address: 2705 Meister Pl, Round Rock, TX 78664

USA Phone: 1.855.478.8284

Email: info@ruvati.com

ATTENTION INSTALLER:

Read all instructions carefully before installation. Inspect the item and make sure you have all the parts shown in the parts list below.

If any part is missing or damaged, please contact Ruvati Support at 1-855-478-8284 or www.ruvati.com.

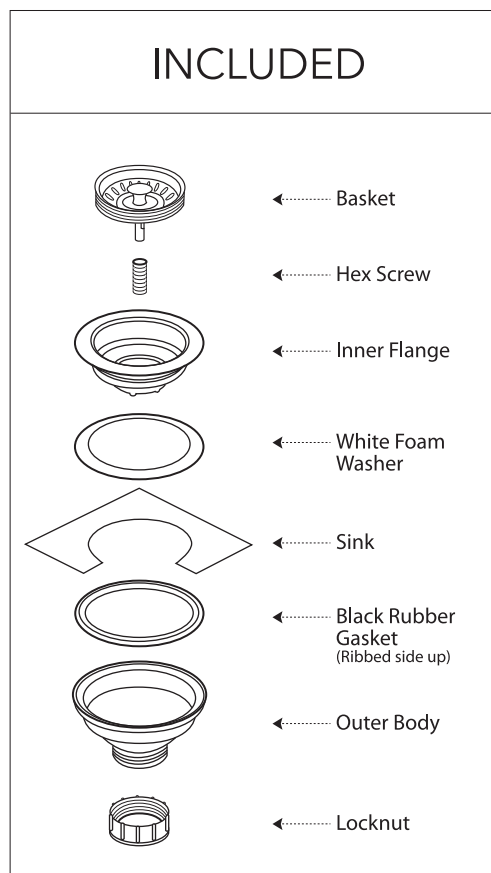

1. Pull out the basket, and look down inside the strainer. You will see a hex screw. Unscrew it using a coin or flat head screwdriver to disassemble the drain [Fig. 1].

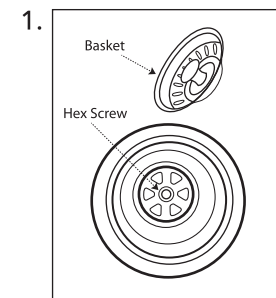

2. Attach the drain to the sink as shown. [Fig 2].

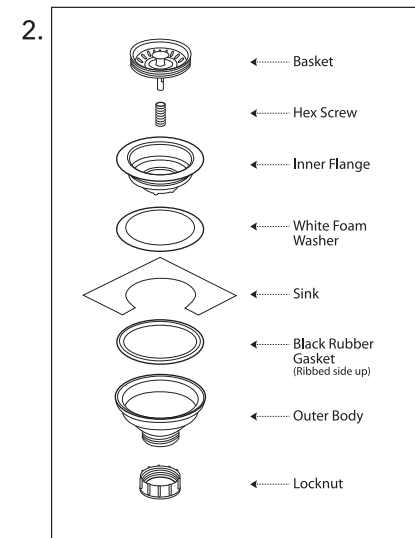

3. The White Foam Washer goes above the sink. You can also use plumber's putty **INSTEAD** of the foam washer. **NOTE:** If you use plumber's putty, do not use the foam washer. You can discard it.

4. The Black Rubber Gasket goes below the sink. Make sure ribbed side is up.

5. Tighten the hex screw with a screw driver or coin to secure the drain assembly to the sink.